

Shims

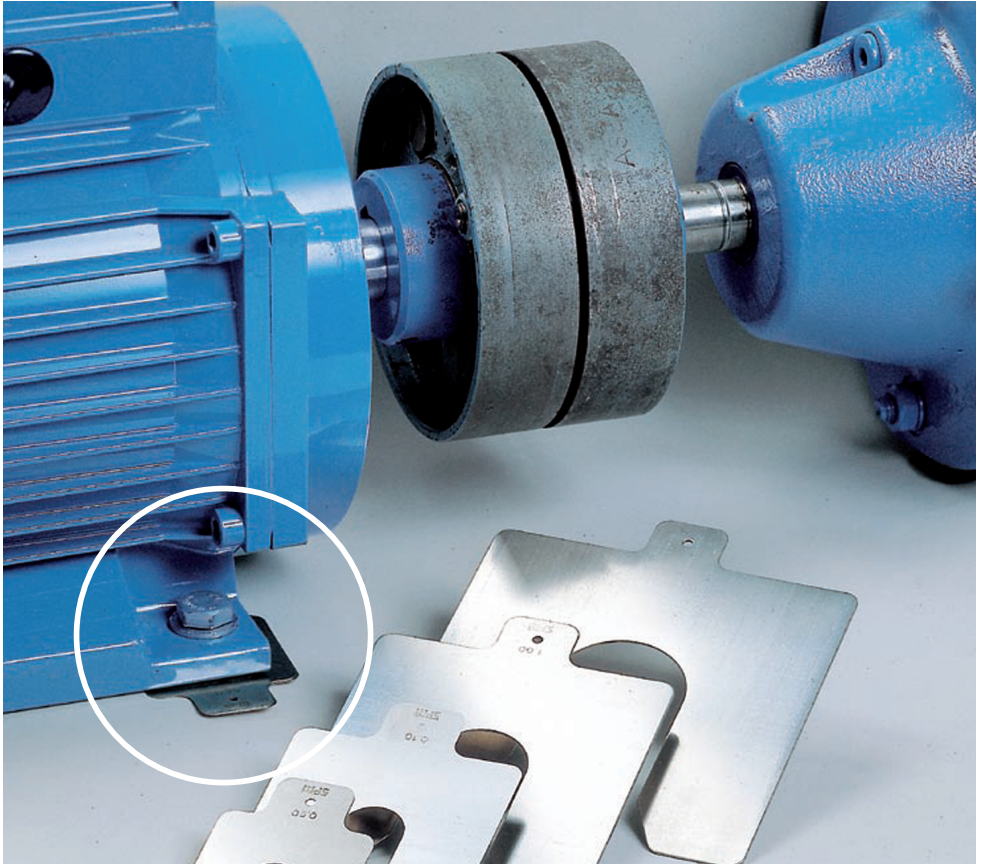

**Make your alignment task
easier and more cost-effective
by using precut shims**

Reduce alignment costs



Precut Shims have many advantages over hand cutting:

- exact thickness and size, the thickness is printed on every shim
- reusability
- massive time saving

SPM Shims are available in 5 sizes, fitting to clamping bolts M12, M18, M27, M36 and M52. You can choose between solid stainless steel shims and laminated shims in either brass or stainless steel.

Solid shims in high grade stainless steel

Solid shims, individually marked with thickness, are available in each size. They come in packs of 10 per thickness from 0.025 mm to 3.00 mm, or in convenient boxes of selected thickness' per size. A selection of thickness' and sizes are available in refillable aluminium framed cases fitted with a compartmentalised high density foam insert.

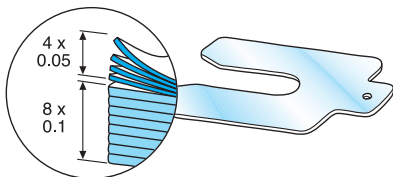

Laminated shims and sheets

Laminated shims are available in each size in pre-cut packs of 20, or uncut sheets, in both brass and stainless steel. Each shim has a thickness of 1.00 mm divided into 12 layers. Laminated shims always fit - just peel off to the required thickness.

with precut shims

10 stainless steel shims, single thickness

| Dimensions | | | Ordering numbers | | | | | |
|------------|-----|----|------------------|--------|--------|--------|--------|--------|
| A | B | C | Thickness (mm) | | | | | |
| 50 | 50 | 13 | 0.025 | 0.05 | 0.10 | 0.20 | 0.25 | 0.40 |
| 75 | 75 | 21 | S1-0025 | S1-005 | S1-010 | S1-020 | S1-025 | S1-040 |
| 100 | 100 | 32 | S2-0025 | S2-005 | S2-010 | S2-020 | S2-025 | S2-040 |
| 125 | 125 | 45 | S3-0025 | S3-005 | S3-010 | S3-020 | S3-025 | S3-040 |
| 200 | 200 | 55 | S4-0025 | S4-005 | S4-010 | S4-020 | S4-025 | S4-040 |
| | | | | S5-005 | S5-010 | S5-020 | S5-025 | S5-040 |

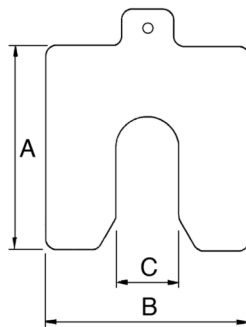

10 stainless steel shims, single thickness

| Dimensions | | | Ordering numbers | | | | |
|------------|-----|----|------------------|--------|--------|--------|--------|
| A | B | C | Thickness (mm) | | | | |
| 50 | 50 | 13 | 0.50 | 0.70 | 1.00 | 2.00 | 3.00 |
| 75 | 75 | 21 | S1-050 | S1-070 | S1-100 | S1-200 | S1-300 |
| 100 | 100 | 32 | S2-050 | S2-070 | S2-100 | S2-200 | S2-300 |
| 125 | 125 | 45 | S3-050 | S3-070 | S3-100 | S3-200 | S3-300 |
| 200 | 200 | 55 | S4-050 | S4-070 | S4-100 | S4-200 | S4-300 |
| | | | S5-050 | S5-070 | S5-100 | S5-200 | S5-300 |

Cases with solid shims

Solid shims in stainless steel are available packaged in convenient aluminium framed cases with a compartmentalised high density foam insert. The refillable cases are available with four different assortments.

Dimensions:

The cases are overall 350 x 160 x 280 mm except for SHIMCASE 4 which is 540 x 210 x 320 mm.

50 stainless steel shims, 10 of each thickness, 0.05 - 1.00 mm

| Dimensions | | | Ordering numbers | |
|------------|-----|----|---|--|
| A | B | C | Thickness 0.05, 0.10, 0.25, 0.50, 1.00 mm | |
| 50 | 50 | 13 | S1-PAK | |
| 75 | 75 | 21 | S2-PAK | |
| 100 | 100 | 32 | S3-PAK | |
| 125 | 125 | 45 | S4-PAK | |
| 200 | 200 | 55 | S5-PAK | |

Ordering numbers,

cases with solid shims:

SHIMCASE 1

360 Shims: 2 x S1-, S2- und S3-PAK + 2 x S1-, S2- und S3-200. Weight 13 kg.

SHIMCASE 2

510 Shims: 2 x S1-, S2- und S3-PAK + 2 x S1-, S2- und S3-020; 0,40; 0,70; 2,00. Weight 17 kg.

SHIMCASE 3

340 Shims: 2 x S3- und S4-PAK + 2 x S3- und S4-020; 0,40; 0,70; 2,00. Weight 15 kg.

SHIMCASE 4

720 Shims: 2 x S1-, S2-, S3- und S4-PAK + 2 x S1-, S2-, S3- und S4-020; 0,40; 0,70; 2,00.

Weight 26 kg.

Laminated shims, pack of 20, thickness 1.00 mm

| Dimensions | | | Ordering numbers | |
|------------|-----|----|------------------|---------|
| A | B | C | Stainless Steel | Brass |
| 50 | 50 | 13 | LS1-PAK | LB1-PAK |
| 75 | 75 | 21 | LS2-PAK | LB2-PAK |
| 100 | 100 | 32 | LS3-PAK | LB3-PAK |
| 125 | 125 | 45 | LS4-PAK | LB4-PAK |
| 200 | 200 | 55 | LS5-PAK | LB5-PAK |

Portable instruments: handy, helpful and low priced.

BearingChecker – State of bearings in your hand

BearingChecker is a handheld, pocket-size, user friendly instrument. It is economical, reliable and straightforward. In an industrial environment, dirt, humidity, splashes and sometimes harsh temperatures are unavoidable. With its robust and ergonomic design, BearingChecker endures the environmental challenges of daily maintenance work. It also withstands the impacts of rough usage. Built-in sensors make BearingChecker a durable and multifunctional instrument.



www.statuspro.com/condition_monitoring/portable_instruments/bearingchecker

VibChecker – Vibration Monitoring made easy

With its built-in probe, easy button operation and clear symbols, VibChecker is an all set to go instrument; just point the probe and measure to locate vibration-related problems. Vibration monitoring is a cost-effective predictive maintenance tool. In most cases, vibration measurement can detect a problem long before damage to the machine has occurred. The repair of equipment failing while in service, is much more expensive than planned repairs made possible through vibration monitoring.



http://www.statuspro.com/condition_monitoring/portable_instruments/vibchecker

BeltTension Pro® – Keep it tight!

Pulley driven transmissions perform best and require a minimum of maintenance when they are well aligned and optimally tensioned. With the BeltTension Pro you can measure the tension quickly and accurately. This instrument is unique because it not only displays the tension, but it can tell you if the tension is too high or too low. It is fitted with a Belt-type database and allows you to store and report measured values.



http://www.statuspro.com/condition_monitoring/portable_instruments/belt_tension_pro



Status Pro Maschinenmesstechnik GmbH

Mausegatt 19

D-44866 Bochum

Phone: + 49 (0) 2327 - 9881 - 0

Fax: + 49 (0) 2327 - 9881 - 81

www.statuspro.com

info@statuspro.com

Distributor